

FLEXIBLE INTERIOR

COMMUNITY PRIORITY #5

Flexibility is key for the interior layout especially in spaces used for community functions.

The Cafeteria will be designed with a raised platform as a stage so it can function for both typical dining and performances with convertible seating.

The Library will be outfitted with flexible furniture throughout that can be rearranged to accommodate multiple classes sharing the space or a community gathering.

CAFETERIA

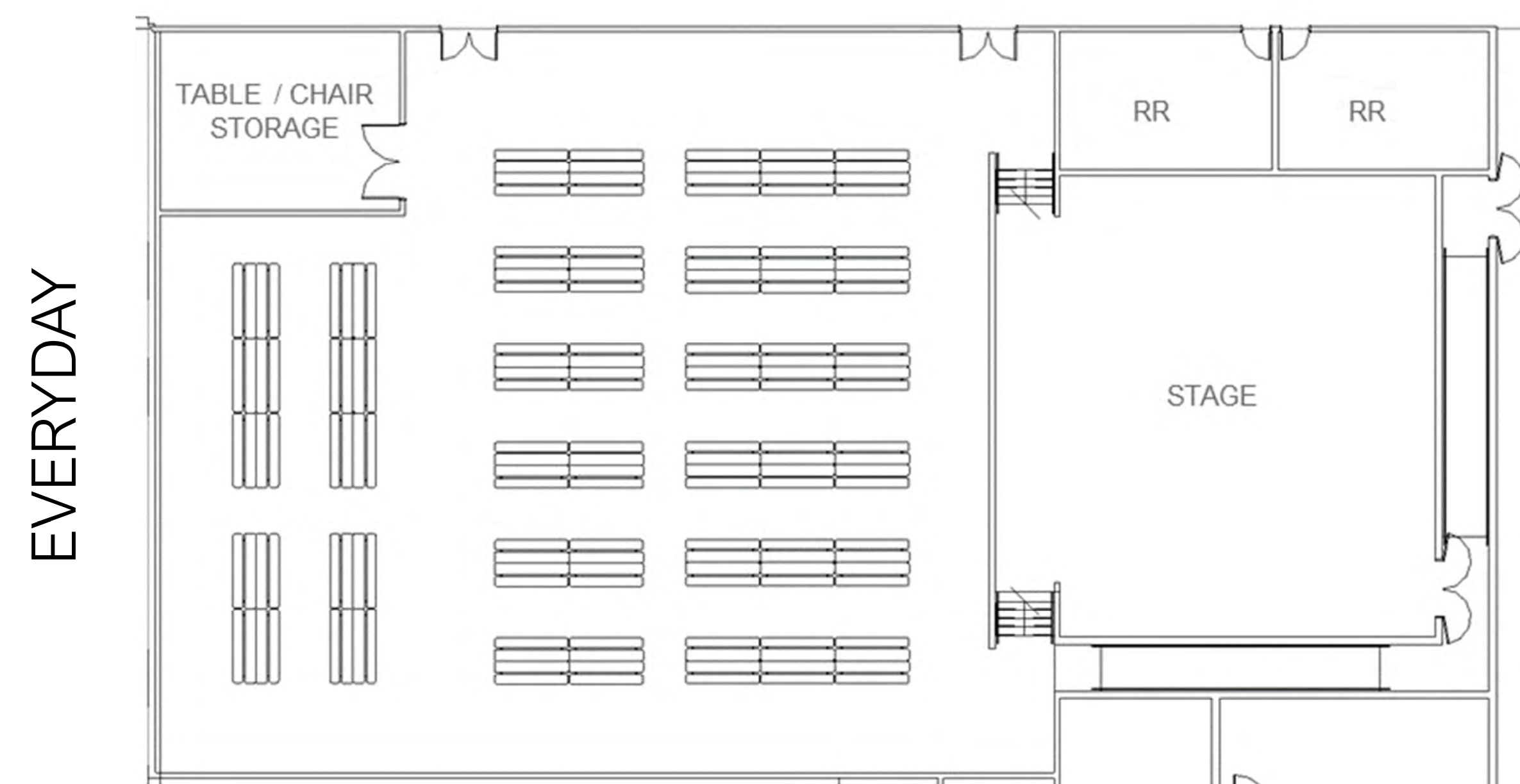

TYPICAL DINING TABLE



CONVERTS TO A BENCH



STACK FOR STORAGE

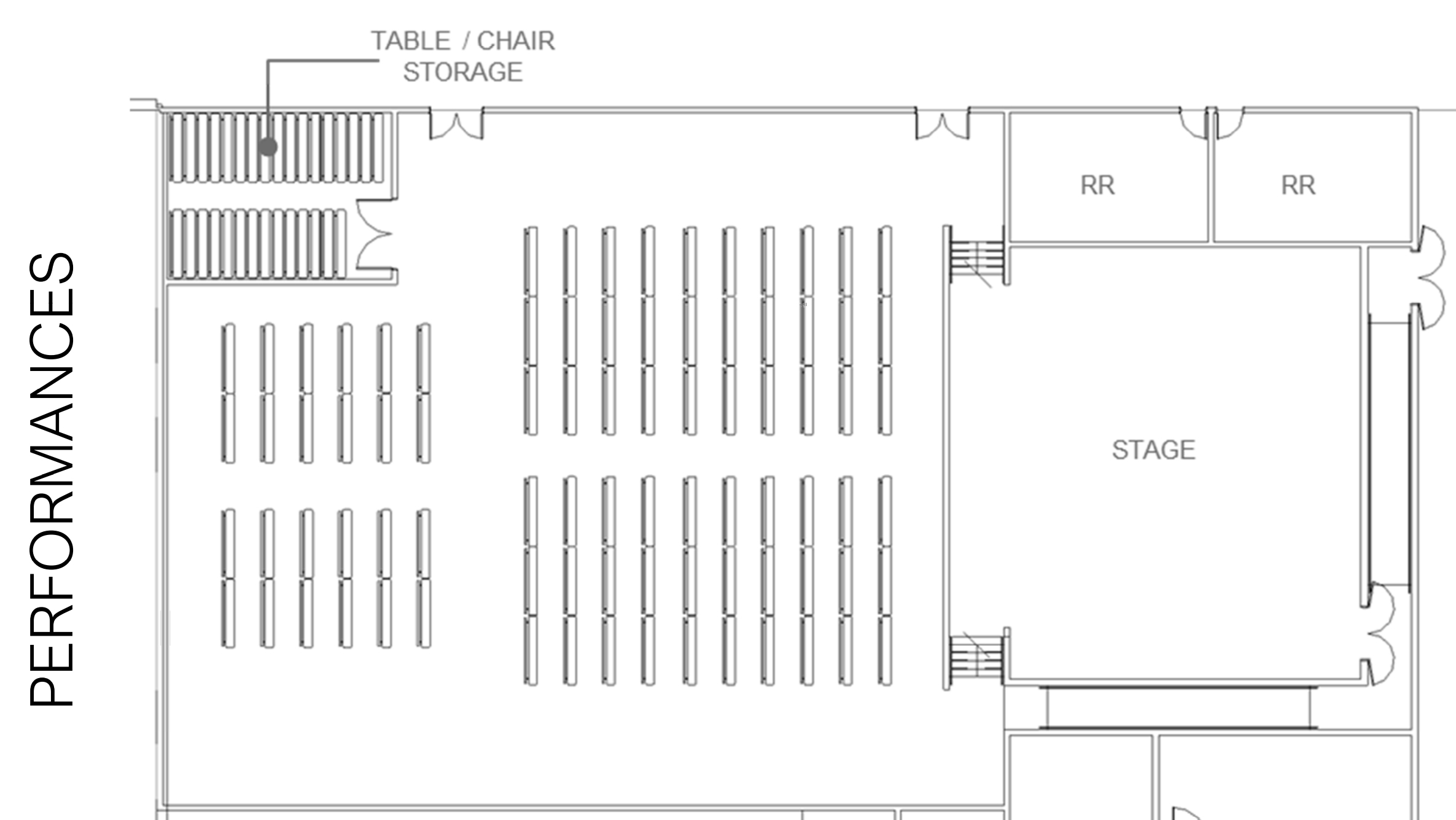

LIBRARY

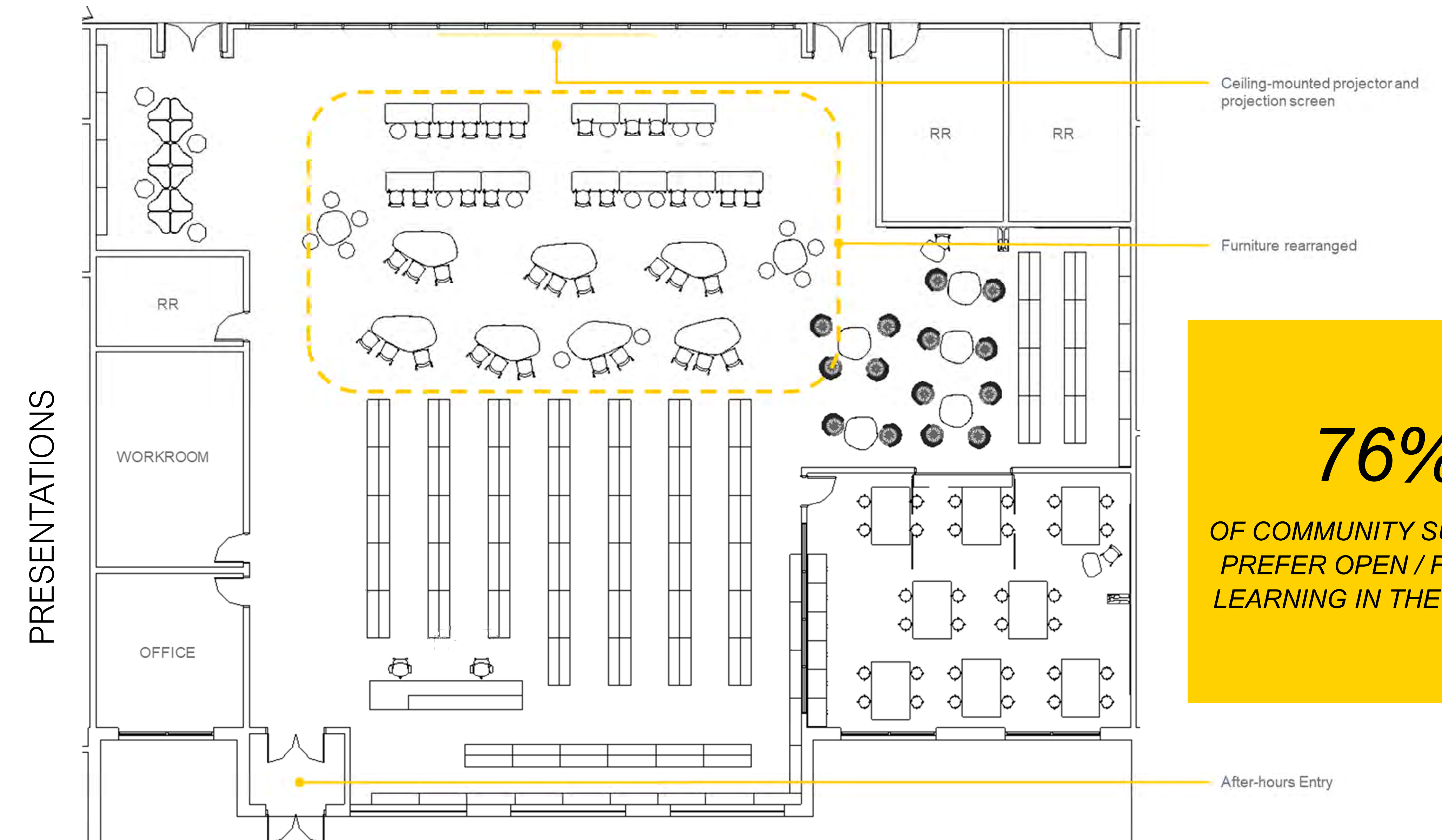
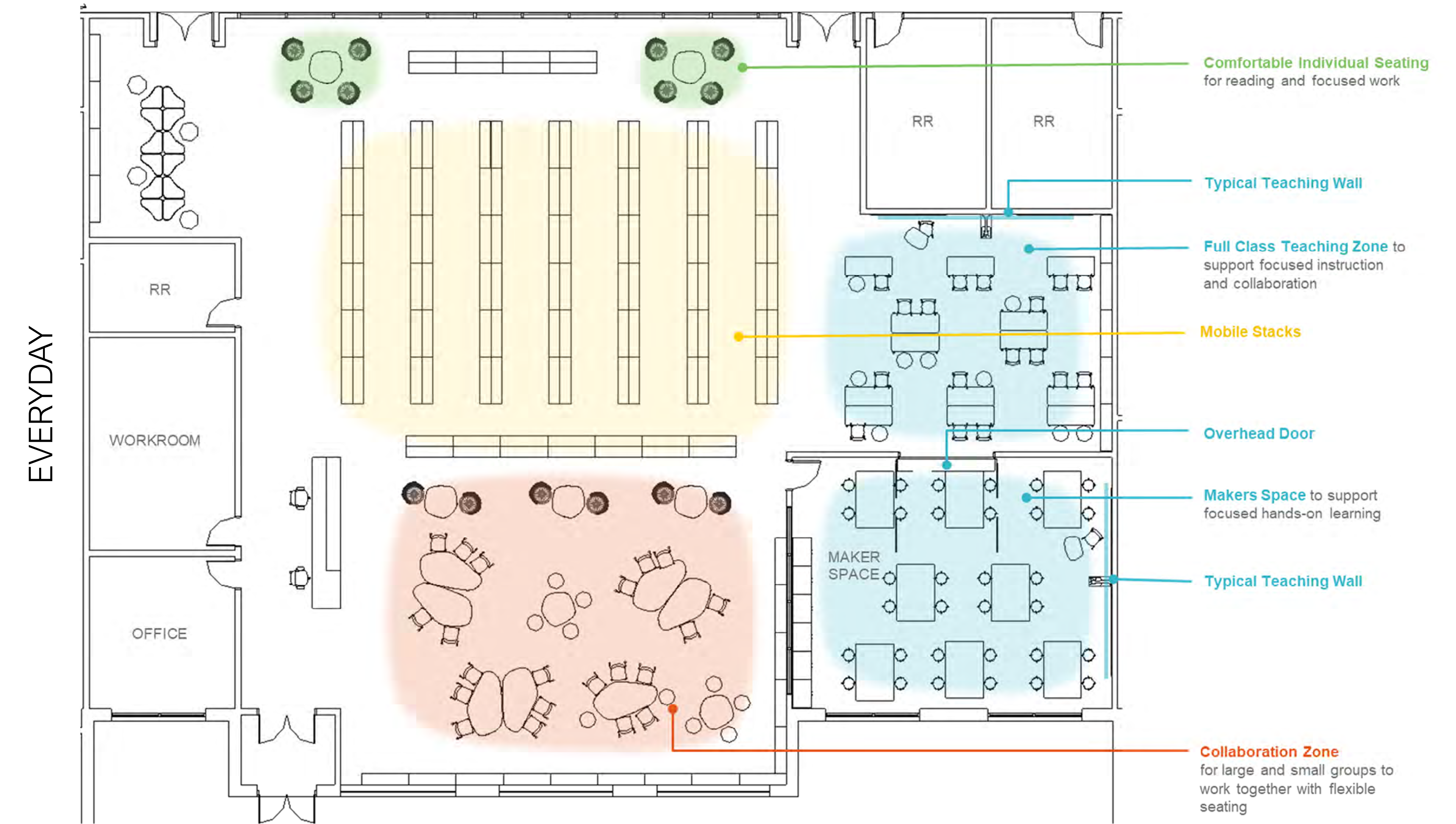

76%
OF COMMUNITY SURVEYED
PREFER OPEN / FLEXIBLE
LEARNING IN THE LIBRARY