



# Red Oak ISD

New Middle School

Rendering Review



CORGAN 

## PROJECT OVERVIEW – WHY A NEW MIDDLE SCHOOL?

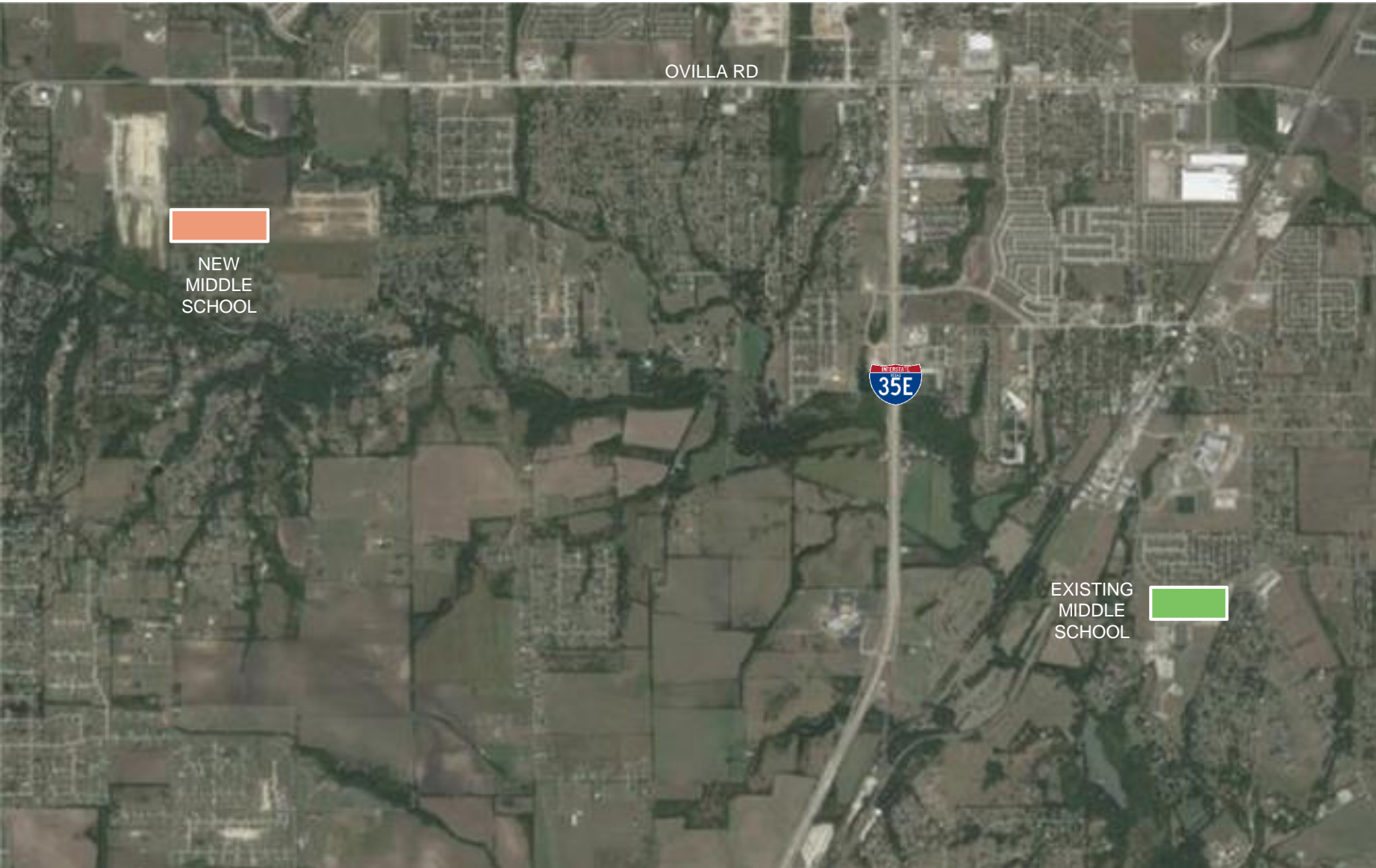

### EXISTING MIDDLE SCHOOL

- Originally designed to be High School & Elementary, repurposed as Middle School
- Current Enrollment: 1,526 Students [09.13.2022]
- The New Middle School will reduce enrollment and equalize between the two facilities.

### NEW MIDDLE SCHOOL

- New 1,200 Student Capacity Middle School
- New Site: 48.485 Acres

COMMUNITY INPUT COMPLETED – 9 events plus survey

NEW ROISD MIDDLE SCHOOL

# DESIGN INPUT

FOR ELEMENTARY PARENTS

5:30-6:30 P.M. AT EACH SCHOOL  
SEPT 14 @ RED OAK ES  
SEPT 15 @ SHIELDS ES  
SEPT 20 @ WOODEN ES  
SEPT 22 @ EASTRIDGE ES  
SEPT 23 @ SCHUPMANN ES



RED OAK ISD

# COMMUNITY COLLABORATION

THE COMMUNITY IS INVITED TO  
OFFER DESIGN INPUT AND IDEAS FOR  
THE POTENTIAL NEW MIDDLE

TUESDAY, SEPT. 27 AND  
THURSDAY, SEPT. 29

ESC BOARD ROOM  
109 W. RED OAK RD.  
STARTING AT 6 P.M.



**ADDITIONAL MEETINGS:**

SEPT 14 – MEETING WITH SUPERINTENDENT STUDENT ADVISORY COUNCIL

SEPT 26 – RED OAK ISD COMMUNITY ADVISORY COUNCIL

# SURVEY RESULTS MATCHED INPUT SESSIONS

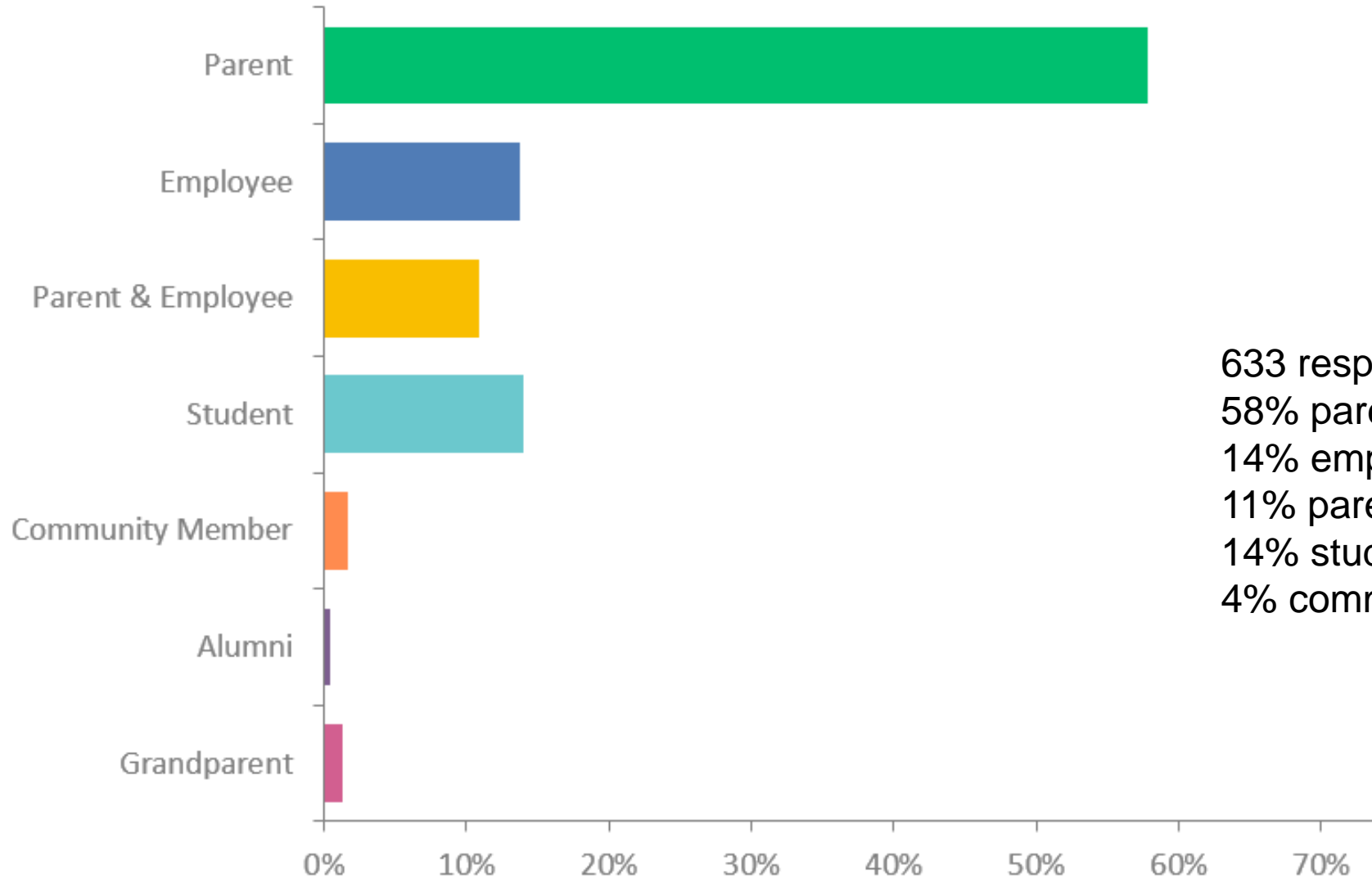

633 respondents:  
58% parents  
14% employees  
11% parent/employee  
14% students  
4% community, alum, grands

## SURVEY RESULTS MATCHED INPUT SESSIONS

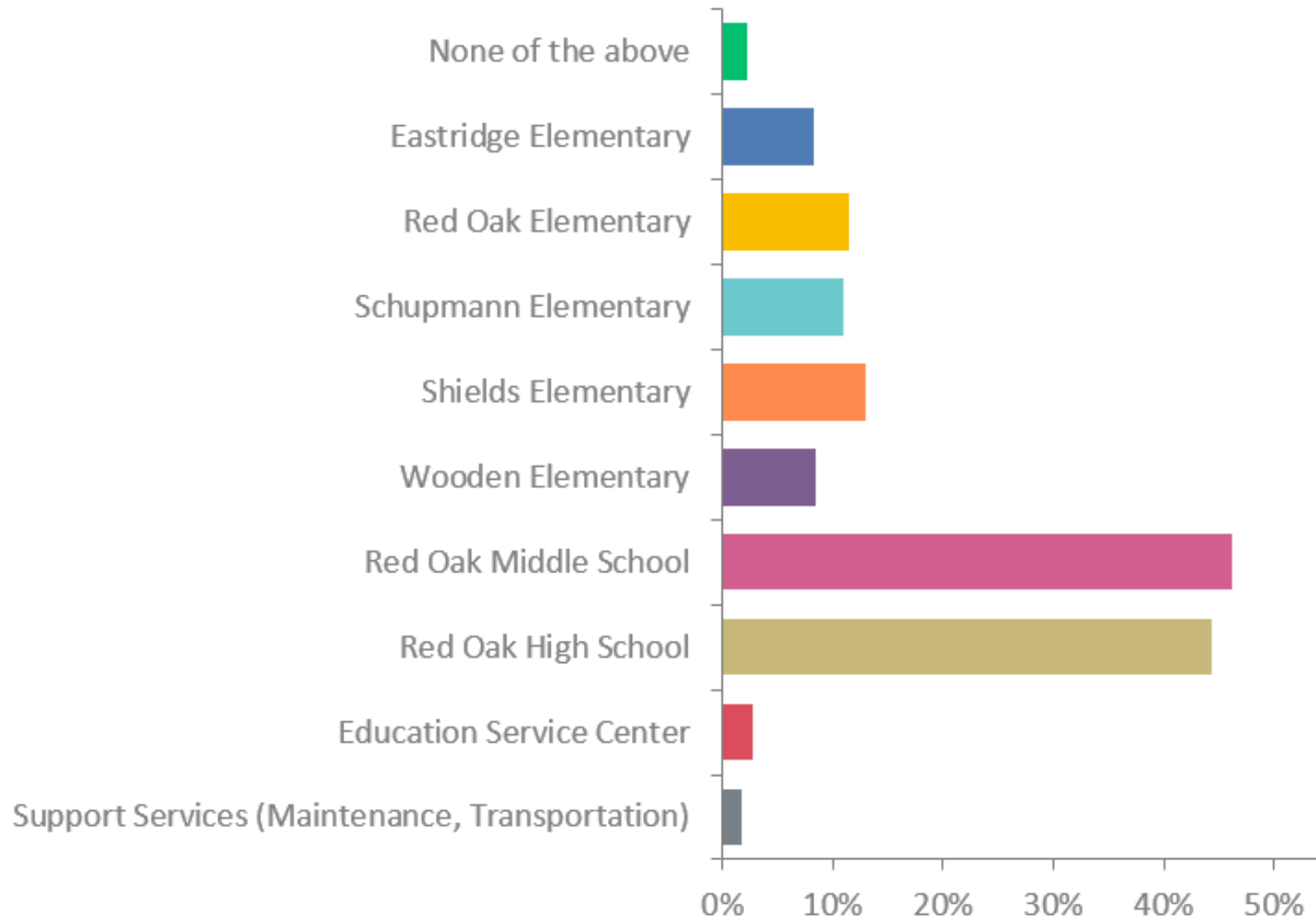

# SURVEY RESULTS MATCHED INPUT SESSIONS

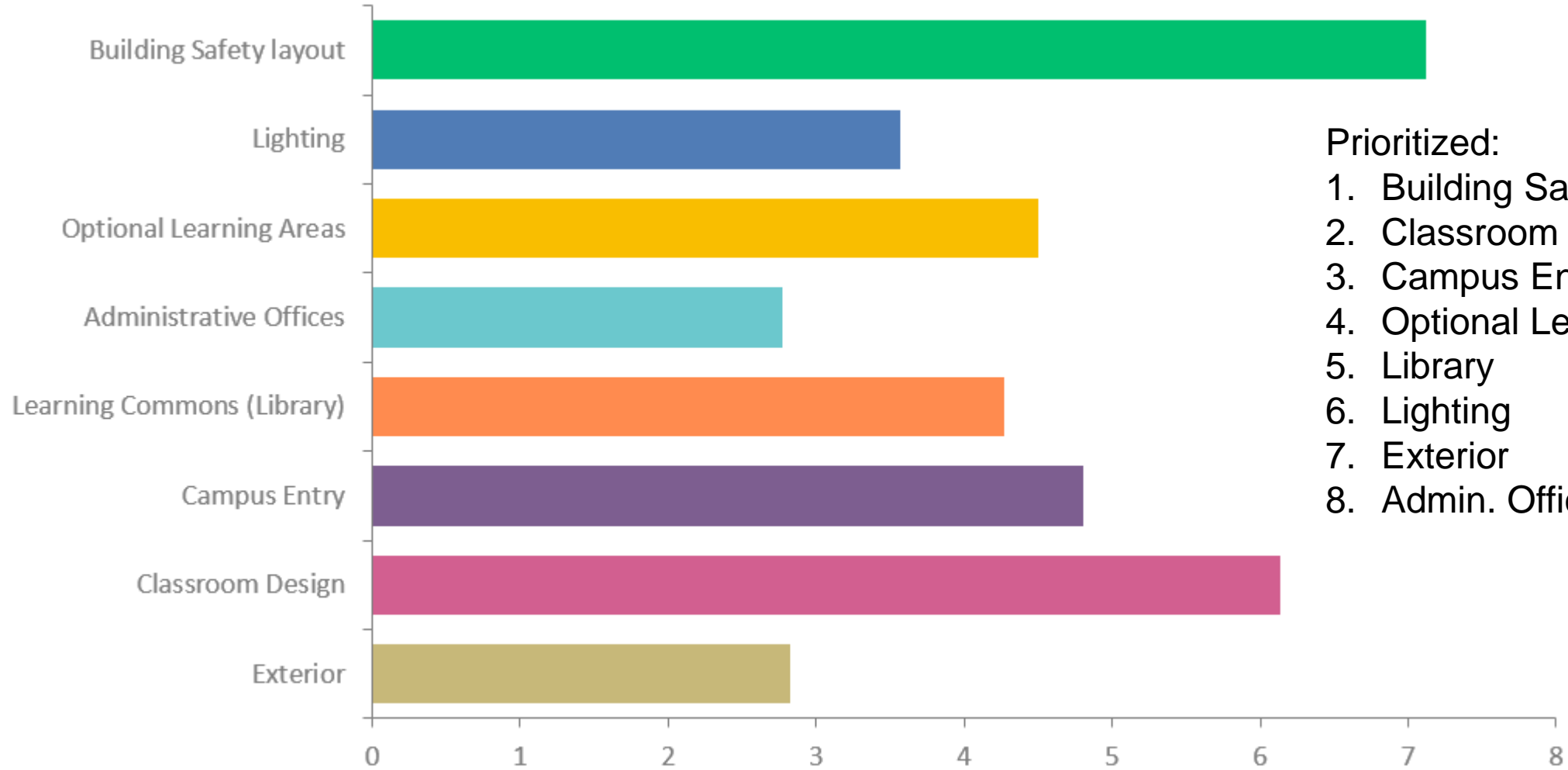

## Building Safety Layout

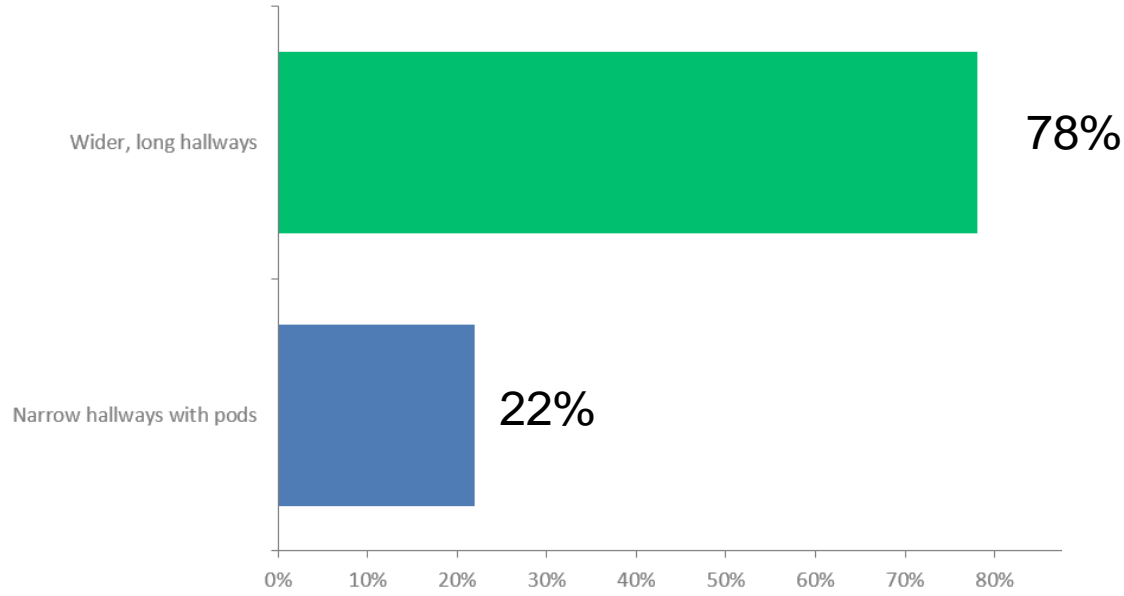

## Classroom Design

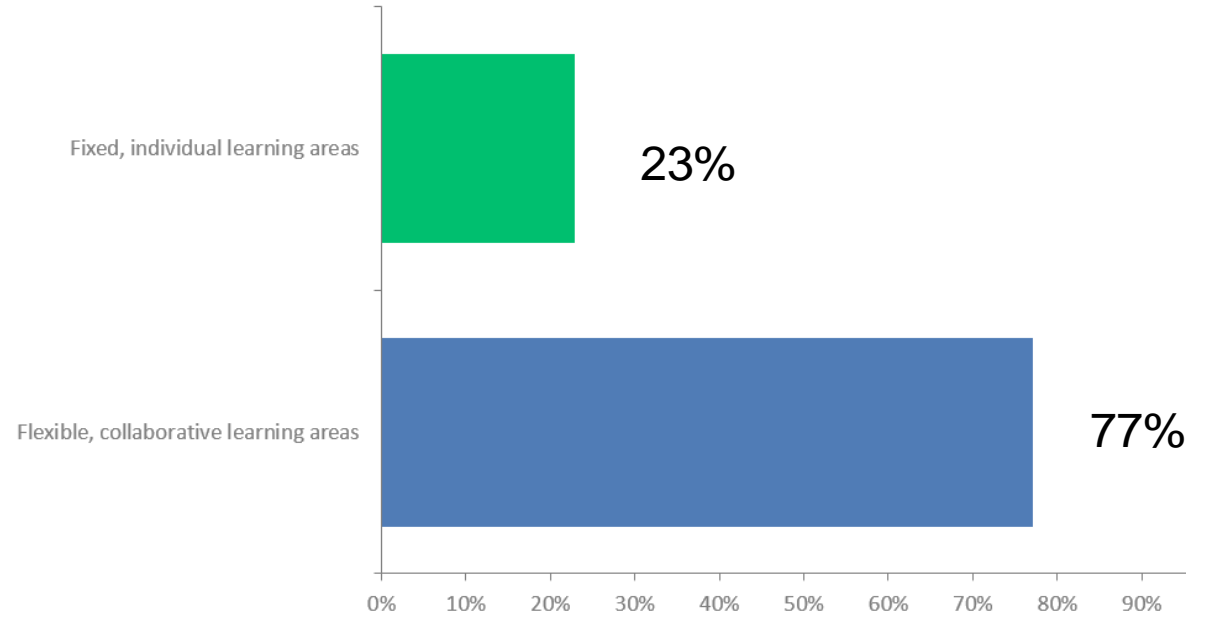

# Optional Learning Areas

## Entry

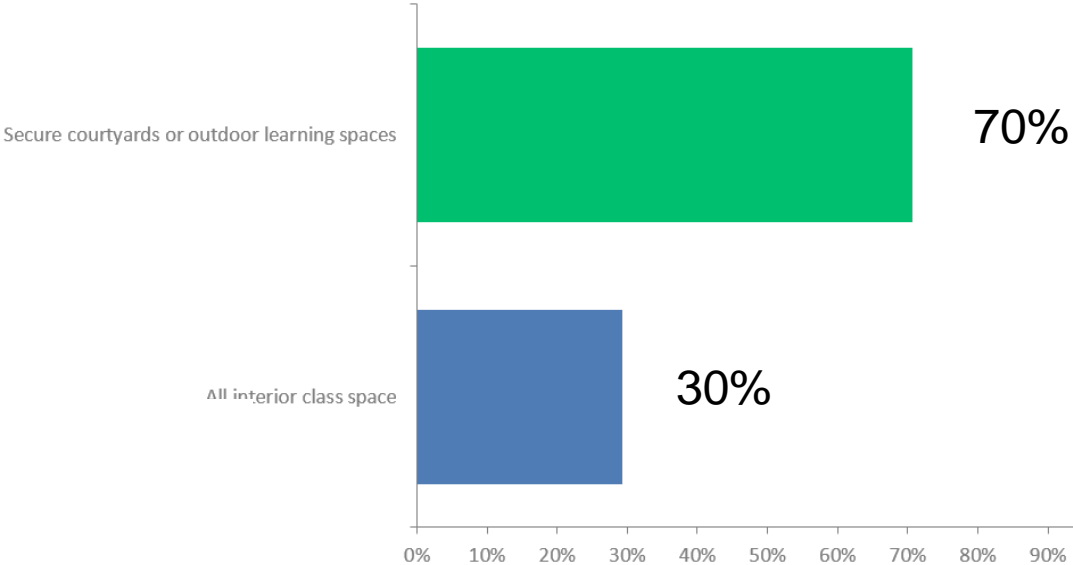
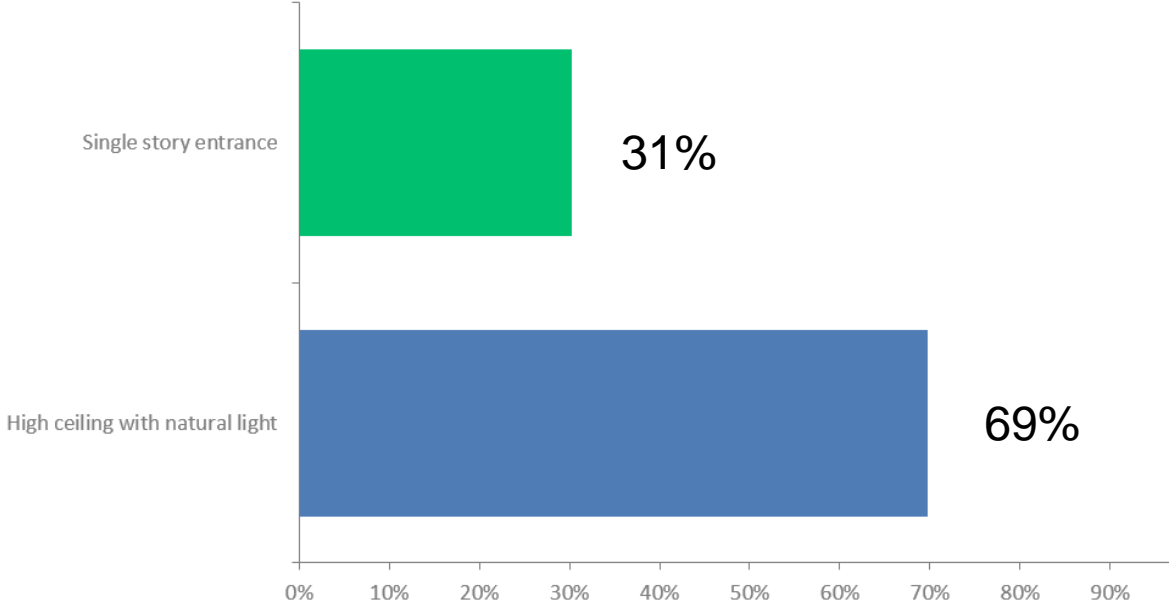



# Lighting

Use of natural light with windows (with safety in mind)

85%

Artificial lighting

15%

0% 10% 20% 30% 40% 50% 60% 70% 80% 90% 100%

# Learning Commons (Library)

Open concept with flexible spaces

76%

Fixed space and defined areas

24%

0% 10% 20% 30% 40% 50% 60% 70% 80% 90% 100%

# Administration Offices

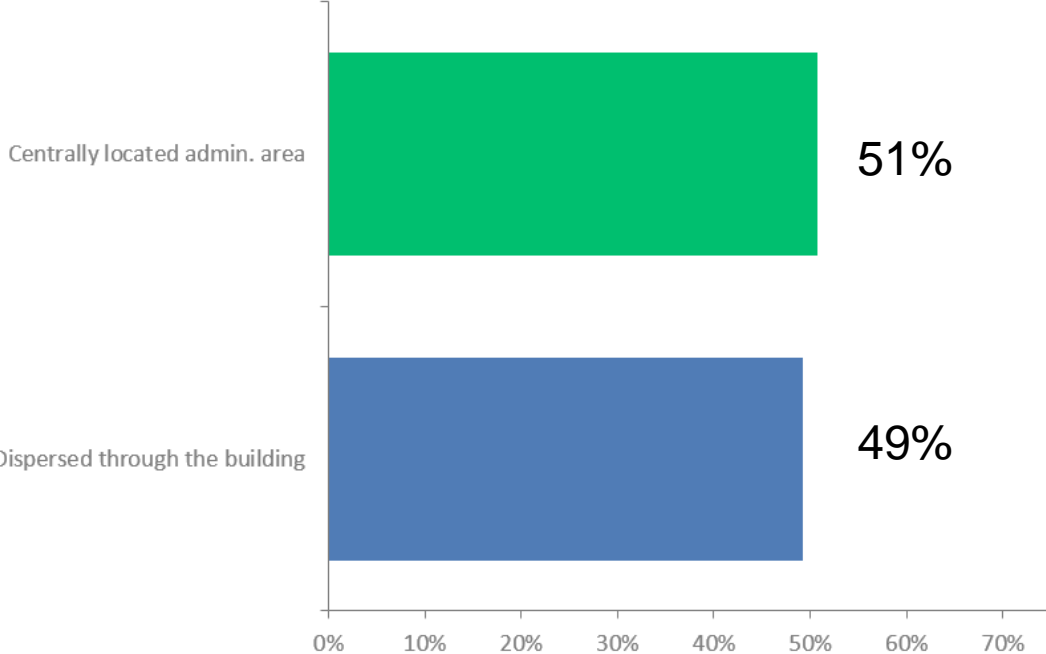

# Exterior

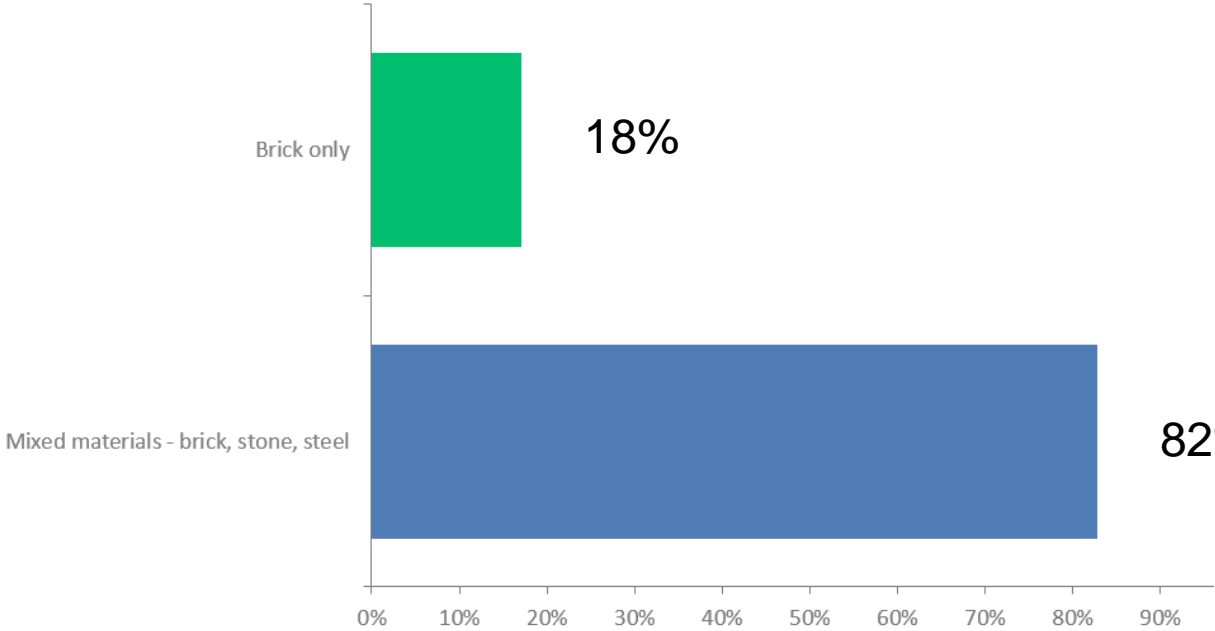

# Design

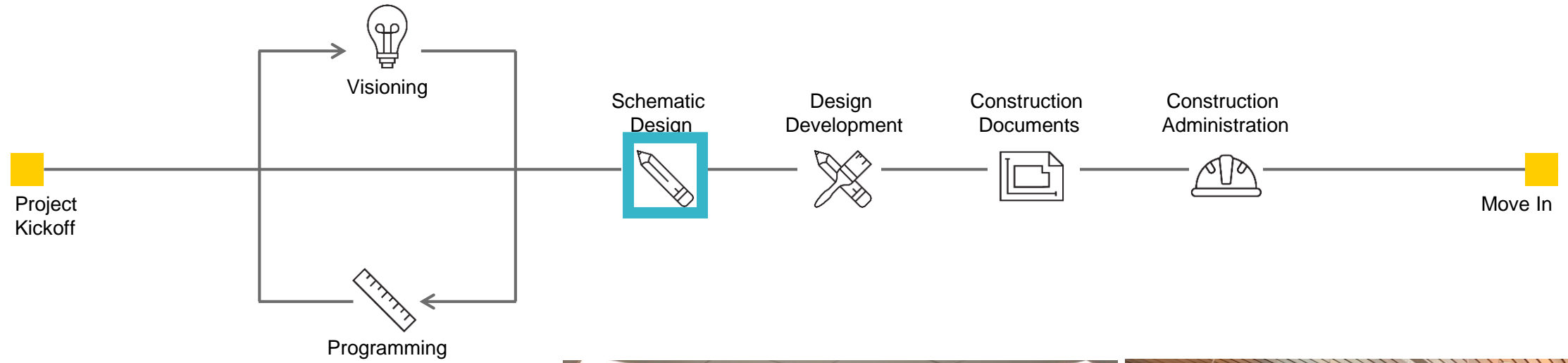

# SITE DESIGN

The security of the building starts with the site.

- Visitors & students will enter through a pick-up and drop-off loop from Westmoreland.
- Visitors will enter the building through a secure vestibule at the main entrance.
- Community entrances to the cafeteria, library & gyms are designed to the south of the building while classroom hallways are designed to the north of the building. This division of public and private spaces reinforces the security of the building.
- The back of the site is primarily accessed for bus drop-off and after-school athletic programs.
- Outdoor athletic facilities are designed to be secured with a perimeter fence and direct access from the building. 200+ parking spaces will be provided per City of Ovilla Ordinances.

## SITE PLAN

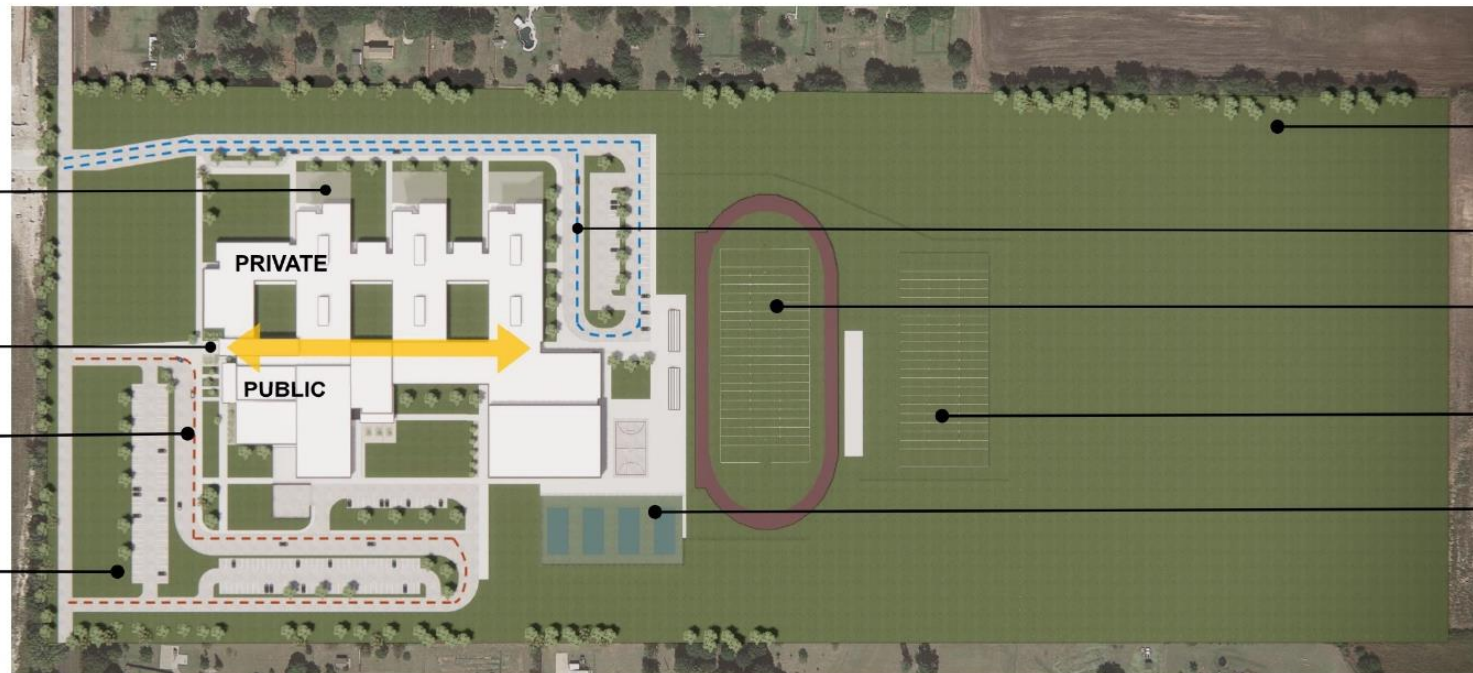

POTENTIAL FOR FUTURE EXPANSION

MAIN ENTRANCE

PICK UP & DROP OFF LOOP  
DESIGNED FOR 1200  
STUDENT CAPACITY

LANDSCAPE PER CITY OF  
OVILLA ORDINANCES

16.9 ACRES FOR POTENTIAL  
FUTURE GROWTH

BUS LOOP DESIGNED FOR 15 BUSES

8 LANE TRACK  
& FOOTBALL FIELD

POTENTIAL PRACTICE FIELD

TENNIS





SP. ED.  
ADMIN

CLASSROOMS

CLASSROOMS

CLASSROOMS

LIBRARY

CAFE  
FINE ARTS

CTE

ATHLETICS

# BUILDING SAFETY

## COMMUNITY PRIORITY #1

- 78% of surveyors want wider, long hallways within the classroom organization to improve security.
- A wide, central hallway separates the PRIVATE classroom spaces to the north and PUBLIC community spaces to the south.
- It is organized with a main entry vestibule and administration at the beginning of this wide central hallway to increase security. This allows visitors to enter the building while keeping classrooms secure.
- Wide hallways continue into the classroom areas and classrooms are organized to have natural light from three secure courtyards.

**78%**

*PREFER WIDER, LONG  
HALLS FOR LINE OF SIGHT*

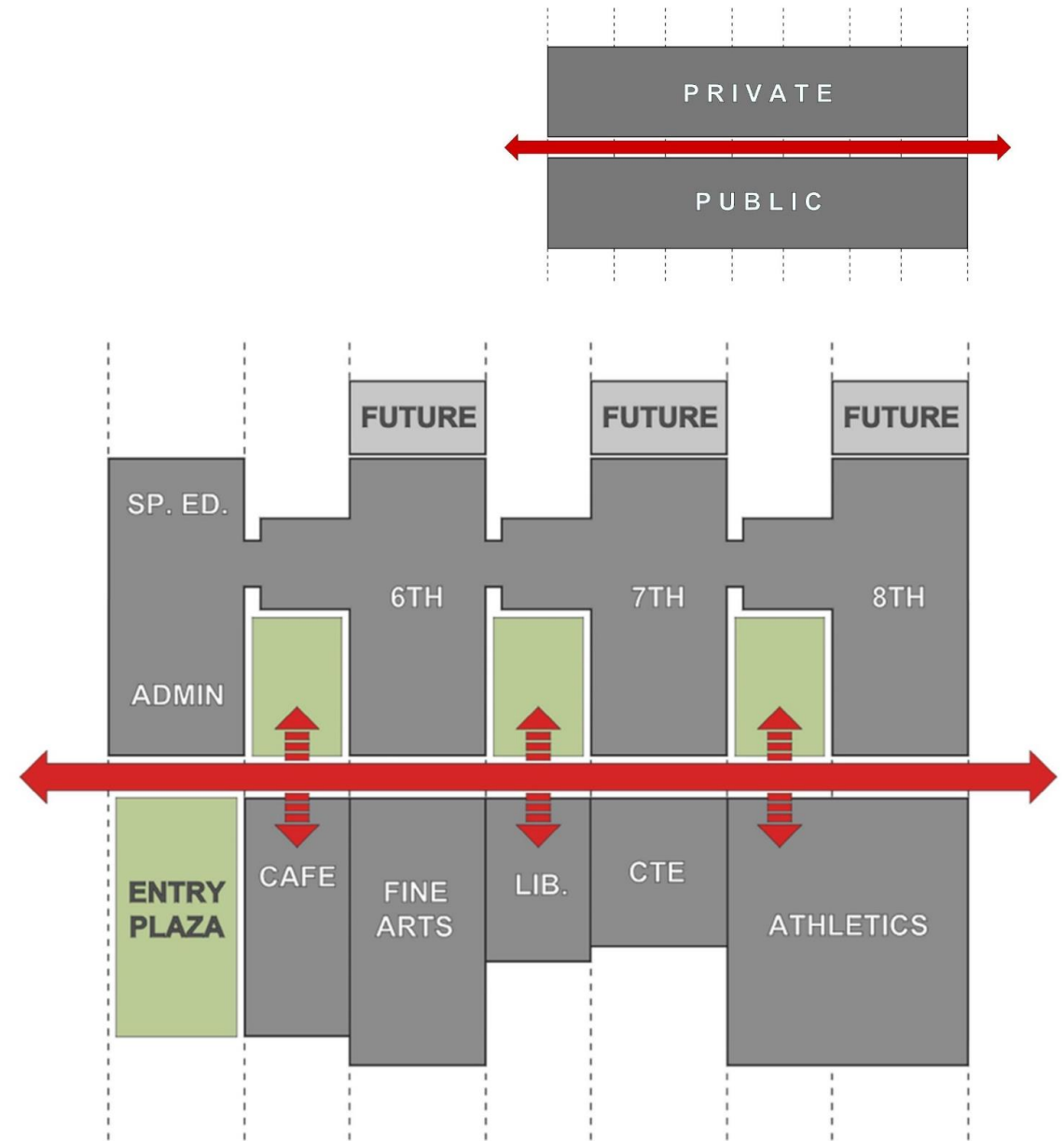

# CLASSROOM

## COMMUNITY PRIORITY #2

- 77% of surveyors want classrooms to be flexible, collaborative learning areas.
- Flexible furniture allows teachers the ability to layout their classrooms to fit the curriculum and gives students the opportunity to change their environment throughout the day.
- Each classroom would also have a primary teaching wall along with plenty of storage for supplies.
- An exterior window provides natural light to every classroom.

77%

PREFER FLEXIBLE,  
COLLABORATIVE,  
LEARNING AREAS

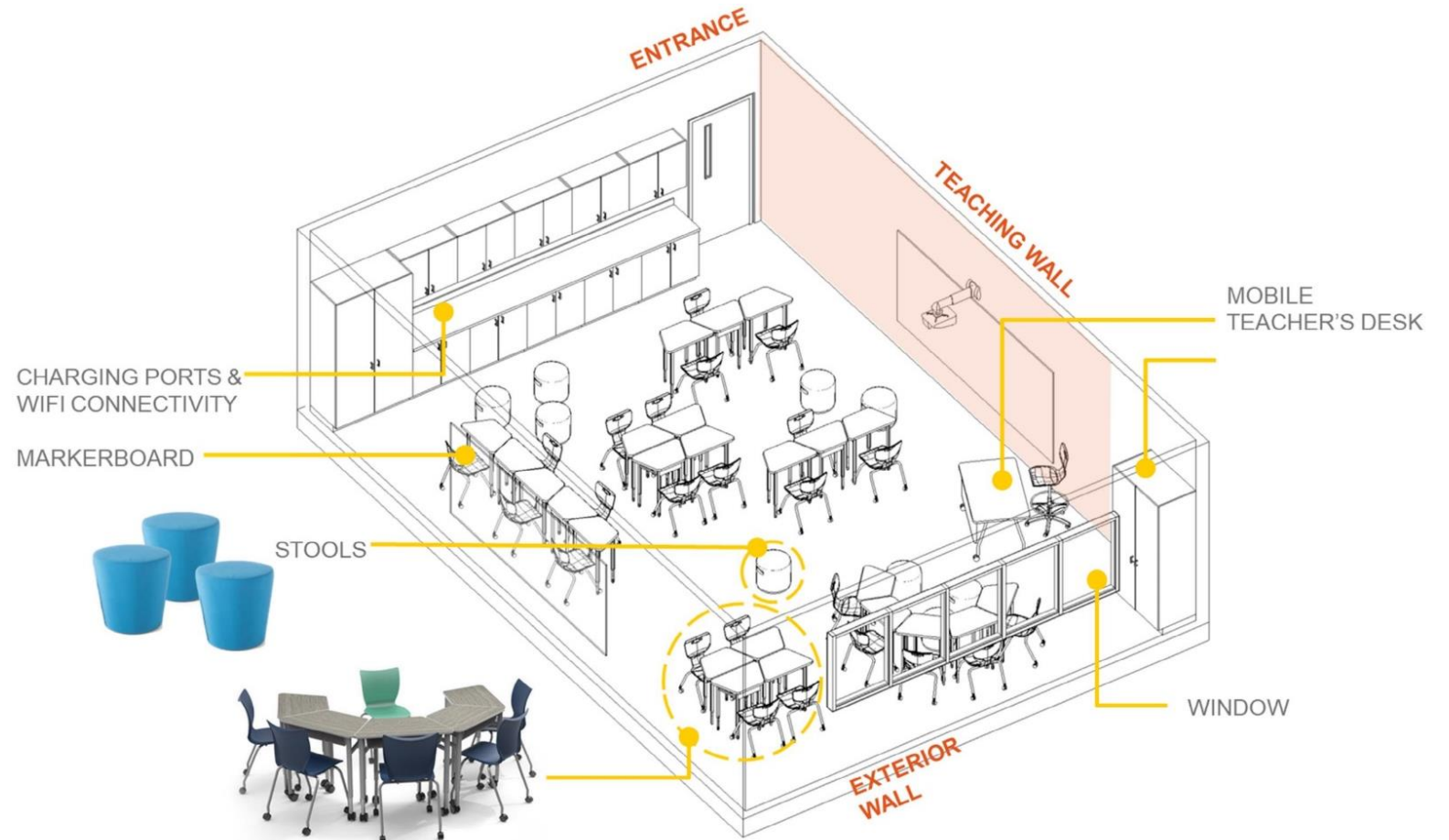

# MAIN ENTRY

COMMUNITY  
PRIORITY #3

## DESIGN FROM COMMUNITY INPUT

Design concepts include three themes:

**Inviting** – Provide a clear front door and welcoming plaza.

**Secure** – Base of solid material. Entry is designed to maximize visibility & monitoring.

**Red Oak Style** – Use of traditional materials with a contemporary expression.

Three concepts were developed. The following design was selected because it reflects the Red Oak community and is the best use of tax dollars.

69%

OF COMMUNITY SURVEYED  
PREFER HIGH CEILINGS  
& NATURAL LIGHT AT  
THE MAIN ENTRY







## MAIN ENTRY RENDERING

This main entry design creates a “Front Porch” to the school. It has a more residential feel to compliment the surrounding neighborhoods. It also provides natural light and visibility to improve security along with high ceilings for a more welcoming appearance. The roof extends out to create an inviting, shaded space to gather.

DESIGN UPDATE

## EXTERIOR MATERIALS

- RED BRICK
- STONE
- WOOD LOOK FINISHES
- BLACK METAL TRIMS & STRUCTURE

**82%**

*OF COMMUNITY SURVEYED  
PREFER BRICK &  
STONE MATERIALS*

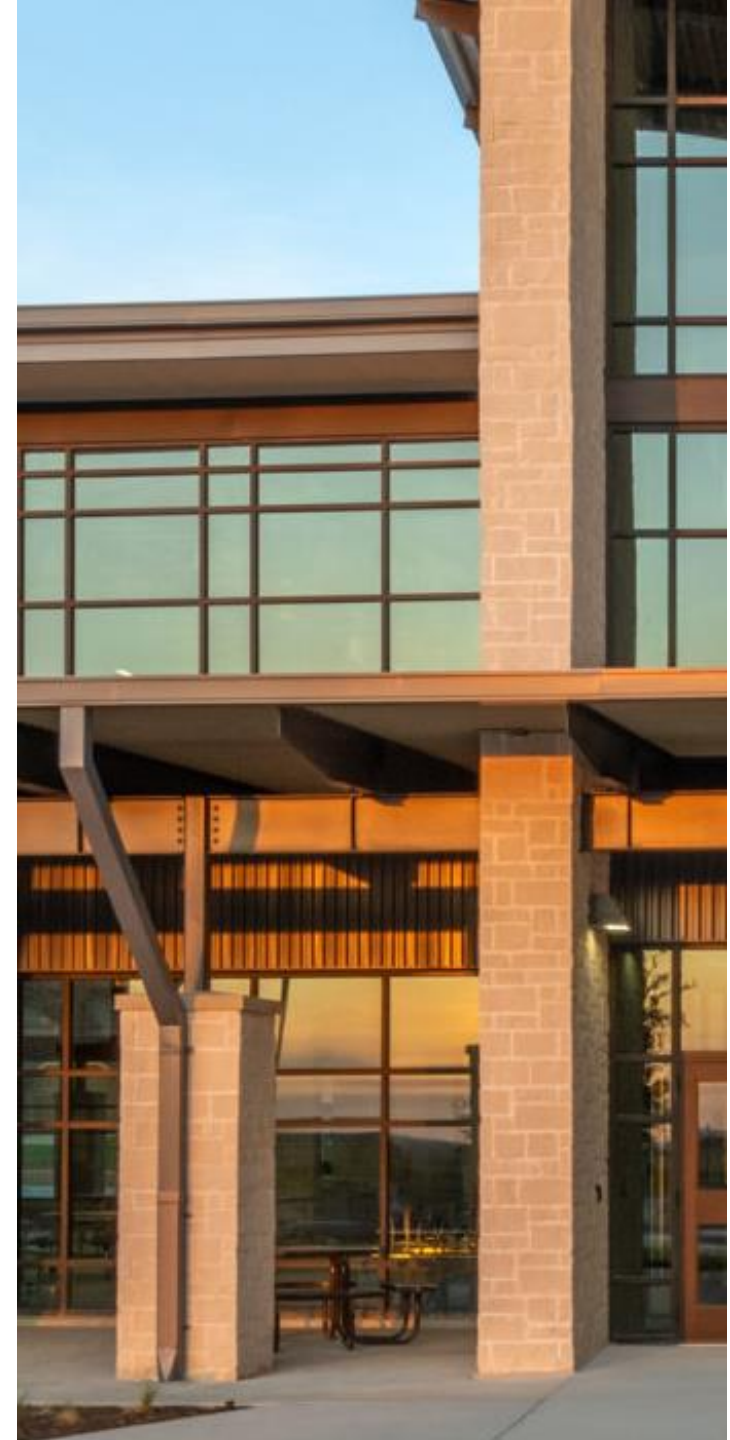
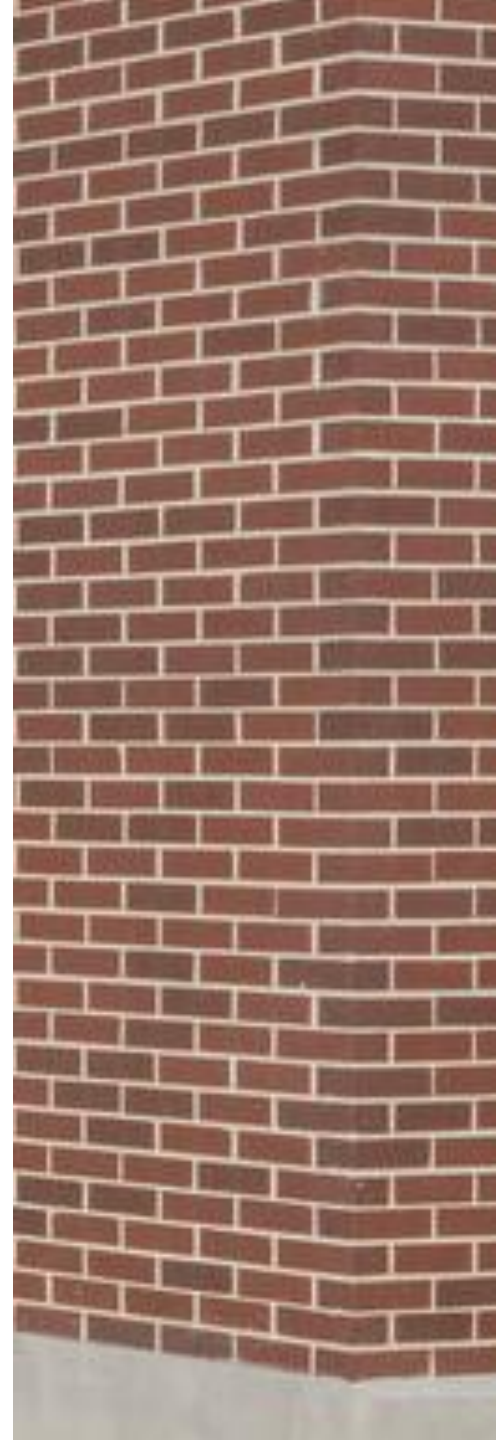

# OUTDOOR LEARNING

COMMUNITY PRIORITY #4

70%

OF COMMUNITY SURVEYED  
PREFER SECURE OUTDOOR  
LEARNING SPACES

- The building design provides a unique opportunity to have three enclosed courtyards that can be used for outdoor learning opportunities.
- Space allows for natural light to interior classrooms.
- Provides for restorative learning by providing students with views to nature as it helps improve focus and reduces stress.

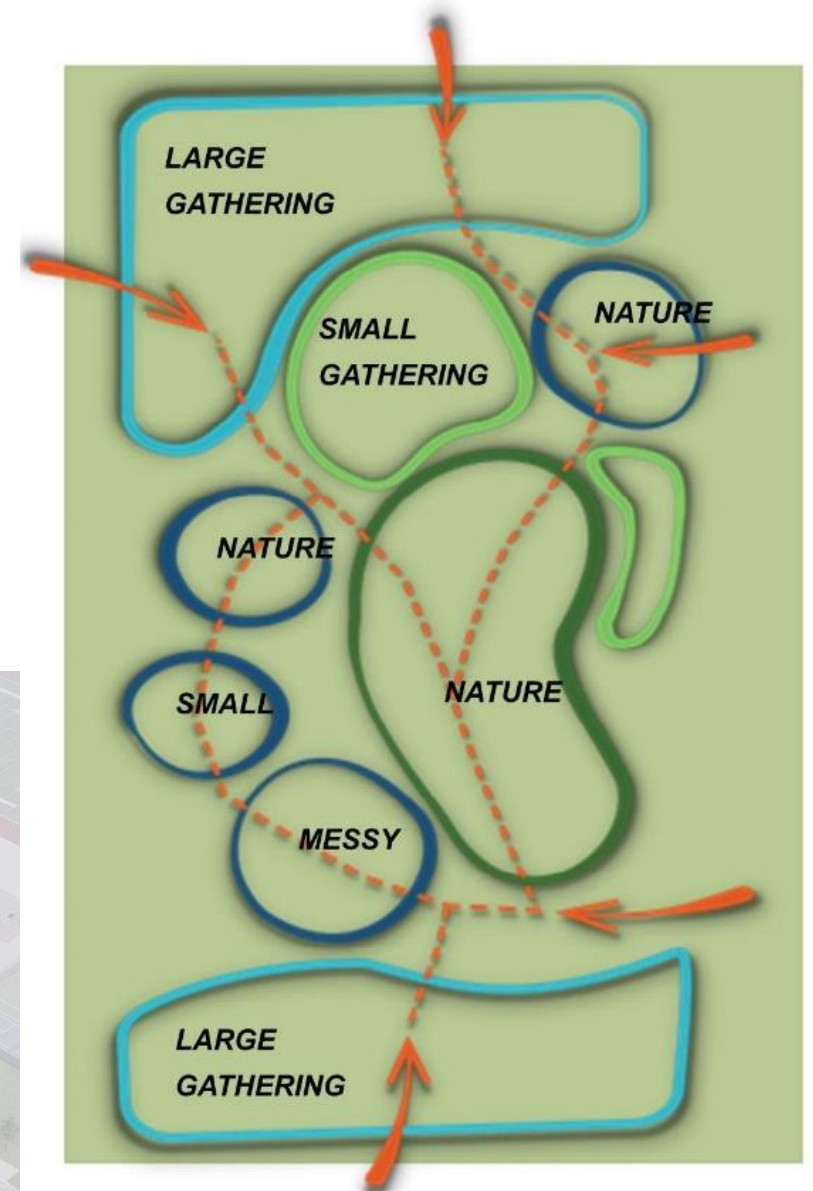
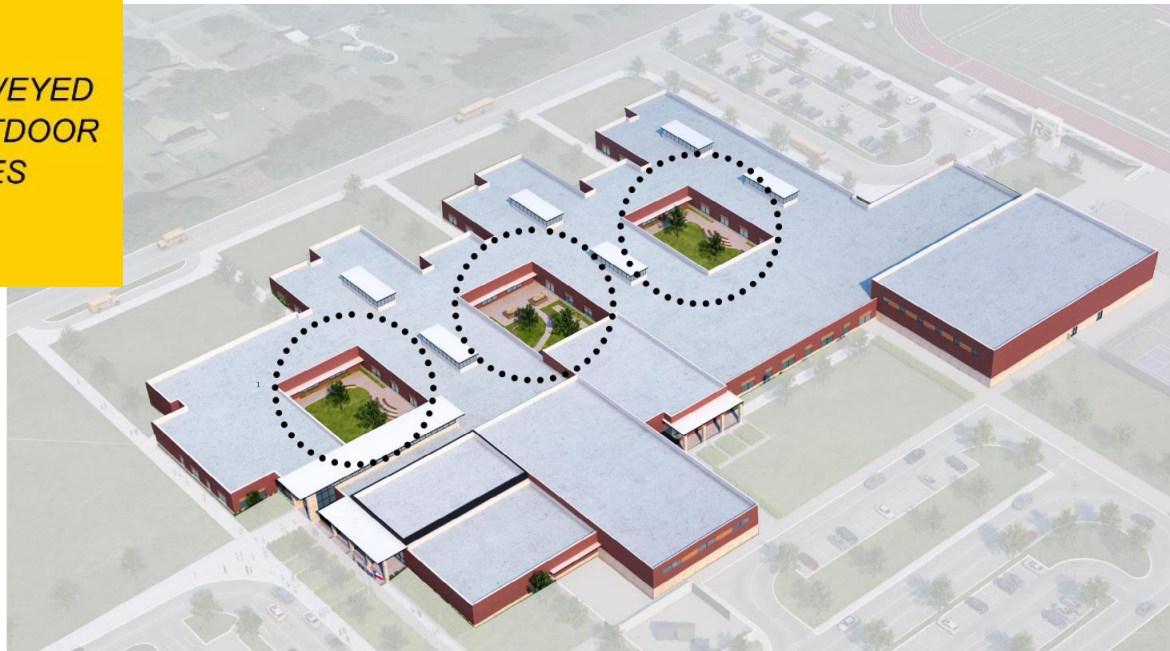

# Outdoor Learning – Courtyard Program / Zones

## Zones:

- 1 Outdoor Classroom/Hand-on Learning Spaces 2 Individual/ Small Group Reflection Spaces 3 Engagement with Nature 4 Spaces for Reflection

### ZONE 1



Gathering spaces for larger groups and outdoor activities. Sheltered but open to nature. More than just classroom outdoors



### ZONE 2



Gathering spaces for smaller groups or individuals. Reflective, relaxed, informal, and nestled in the landscape

### ZONE 3



Nature-focused, accessible learning spaces for independent and guided exploration. Geared for hands-on learning and observation

### ZONE 4



More open space for recreation, can incorporate vegetation for sound/visual buffering and for ecosystem services

# LEARNING COMMONS

76%

OF COMMUNITY SURVEYED  
PREFER OPEN / FLEXIBLE  
LEARNING IN THE LIBRARY

## COMMUNITY PRIORITY #5

Learning Commons include:

- Collaborative spaces for large and small groups;
- Individual and project work areas;
- An available Maker Space which can be used in conjunction or separate; and
- Area also available for community events.

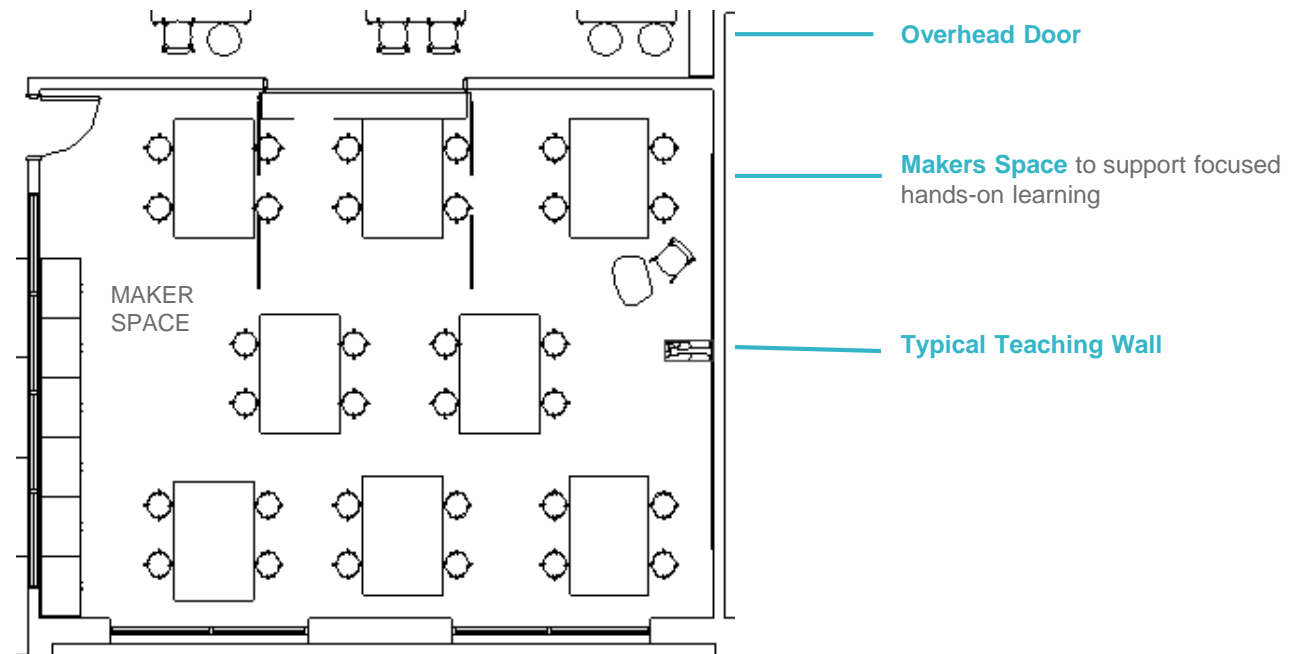

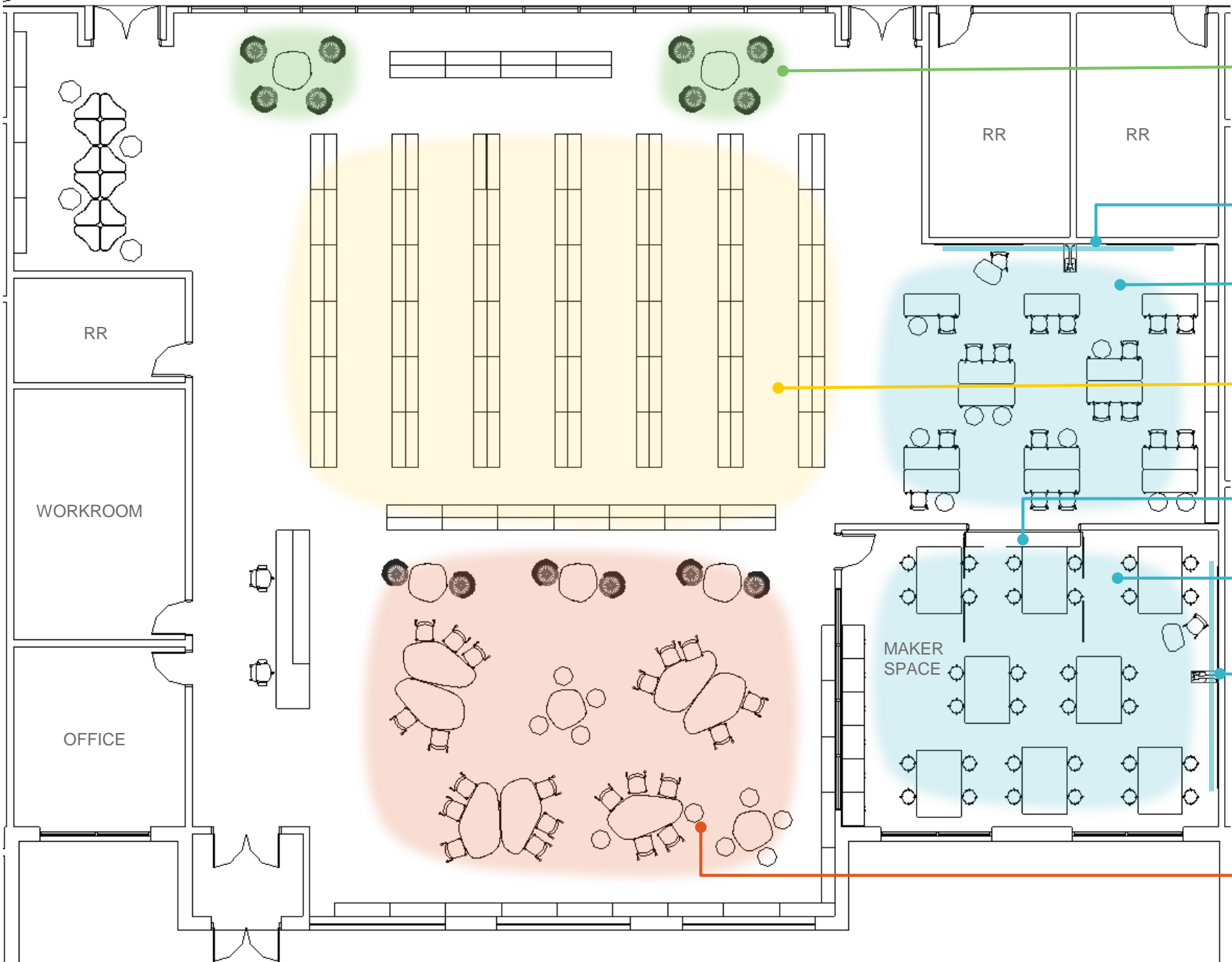

Comfortable Individual Seating for reading and focused work

Typical Teaching Wall

Full Class Teaching Zone to support focused instruction and collaboration

Mobile Stacks

Overhead Door

Makers Space to support focused hands-on learning

Typical Teaching Wall

Collaboration Zone for large and small groups to work together with flexible seating

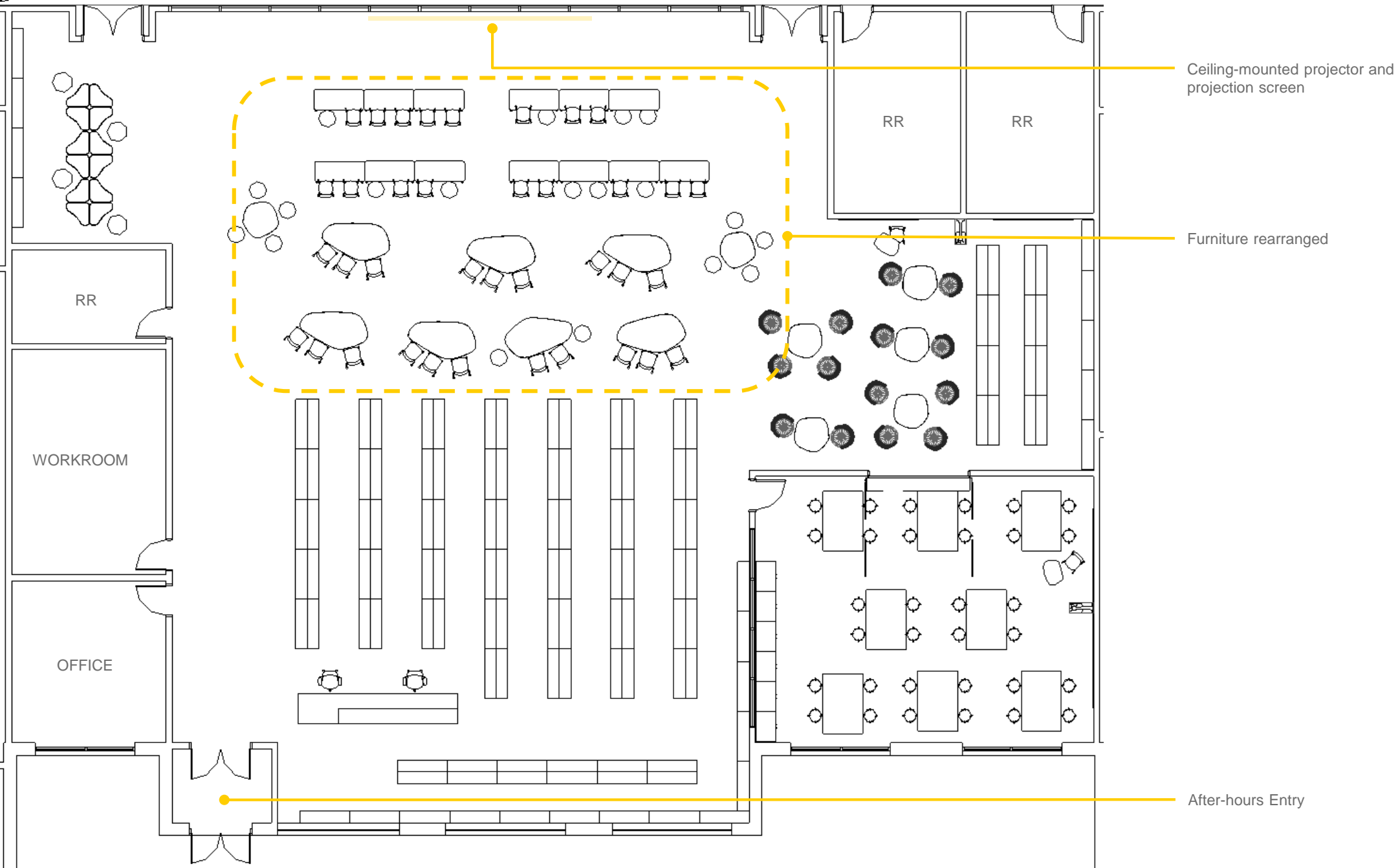

# Everyday Cafeteria

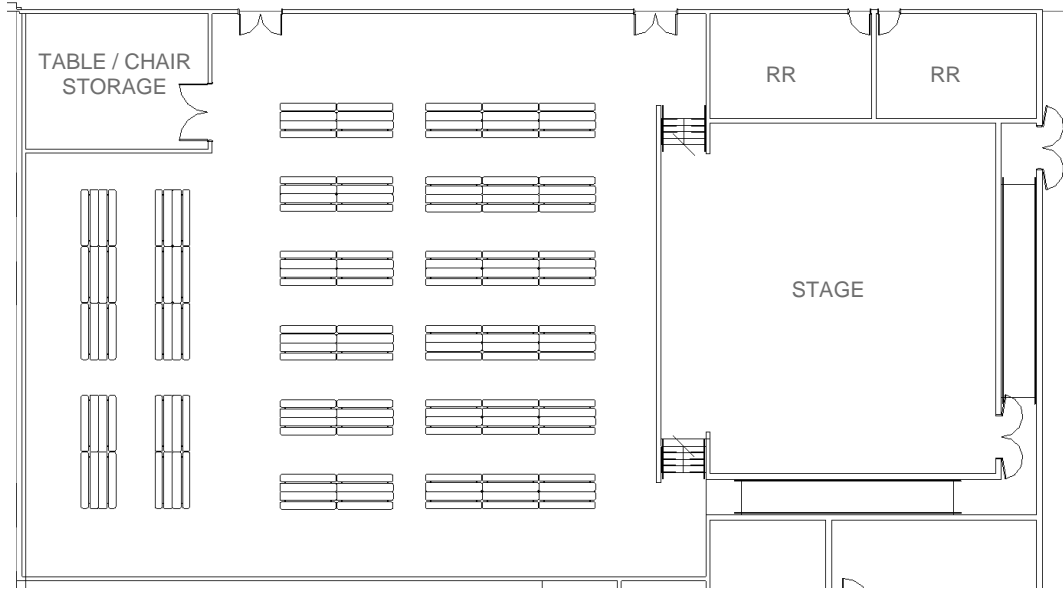

# Performance Cafeteria

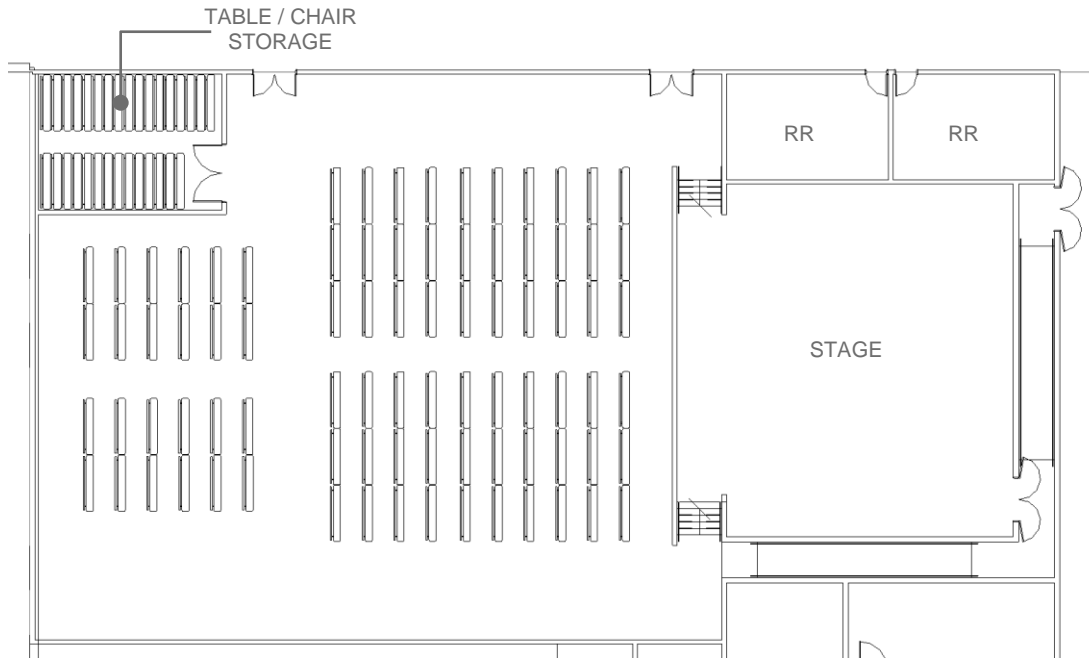



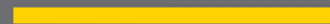
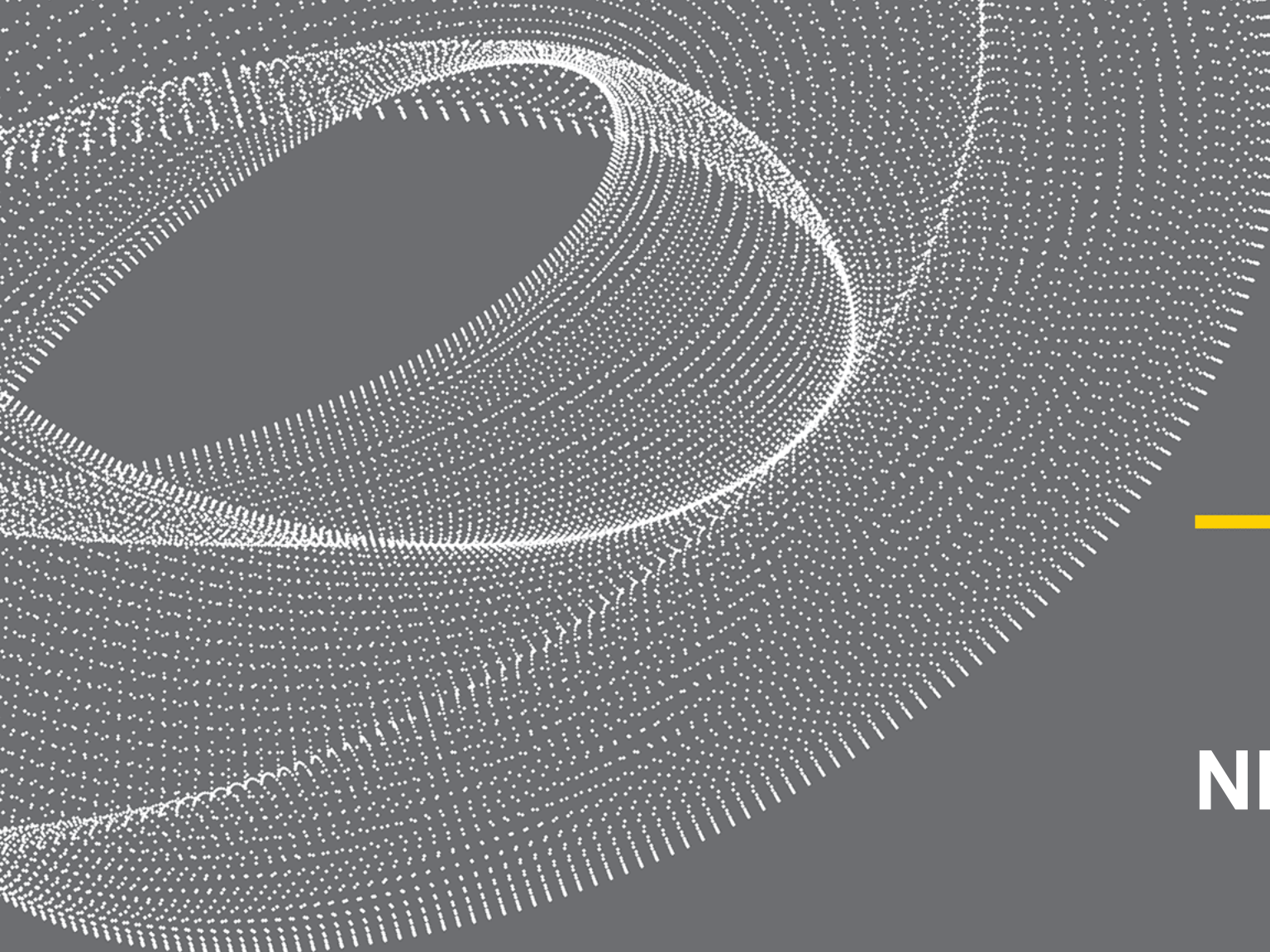

**NEXT STEPS**

NEXT STEPS

## Meet with Programming Groups

Review plan development

**Core Curriculum**

**Specialized  
Learning**

**Science**

**Career Tech Ed**

**Fine Arts**

**Athletics**

**Administration**

**Security**

**Library**

**Technology**

**Mechanical  
Systems**



NEXT STEPS

**EARLY VOTING - October 24 - November 4 (times vary)**

The Cowboy Church of Ellis County (Ranch House)  
Red Oak Municipal Center (Evelyn Pitts Room)

**ELECTION DAY - Tuesday, November 8, 7 a.m. to 7 p.m.**

Red Oak Municipal Center (Evelyn Pitts Room)  
Eastridge Baptist Church (Gym)

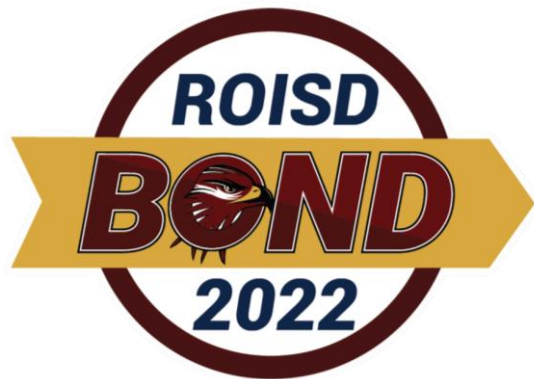

Website – [www.roisdbond.com](http://www.roisdbond.com)